

## 1.Packing List

Open the packing box, please check whether the packing list is complete and the items are in good condition.

Packing list	Qty	Unit
Doorcam	1	pc
Indoor unit	1	pc
Battery	1	pair
Screw	1	bag

## 2.Appearance Introduction

WiFi Doorcam

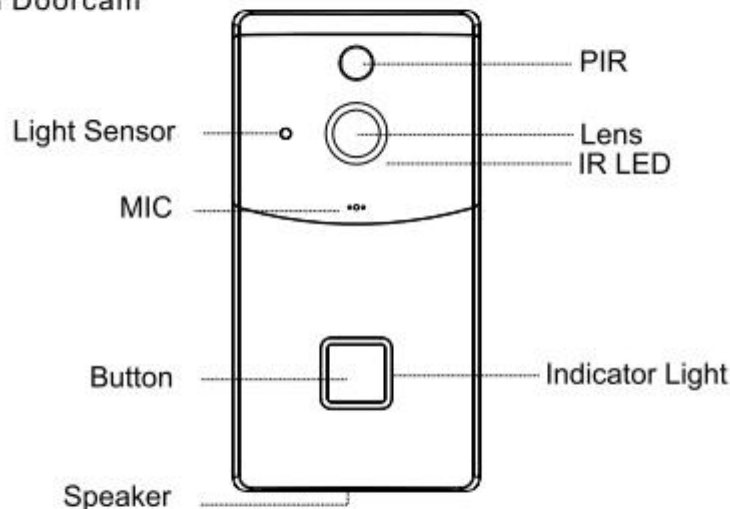

<b>IR LED</b>	Infrared light
<b>Light Sensor</b>	Used to detect enviromental brightness value
<b>MIC</b>	Audio capture
<b>Button</b>	The doorbell button
<b>PIR</b>	To detect visitors
<b>Lens</b>	Video image capture
<b>Indicator Light</b>	<b>Red light flashing for 2s per 2s:</b> The device is waiting for WiFi connection. <b>Red light solid on:</b> The user joined to the hotspot successfully <b>The blue light flashing for 0.5s per 0.5s:</b> The device is connecting to the router <b>Blue light solid on:</b> Device connected to the router.

**Blue light flashing for 2s per 2s:** Device failed to connect to the router

Issue voice prompt and voice intercom

**Speaker**

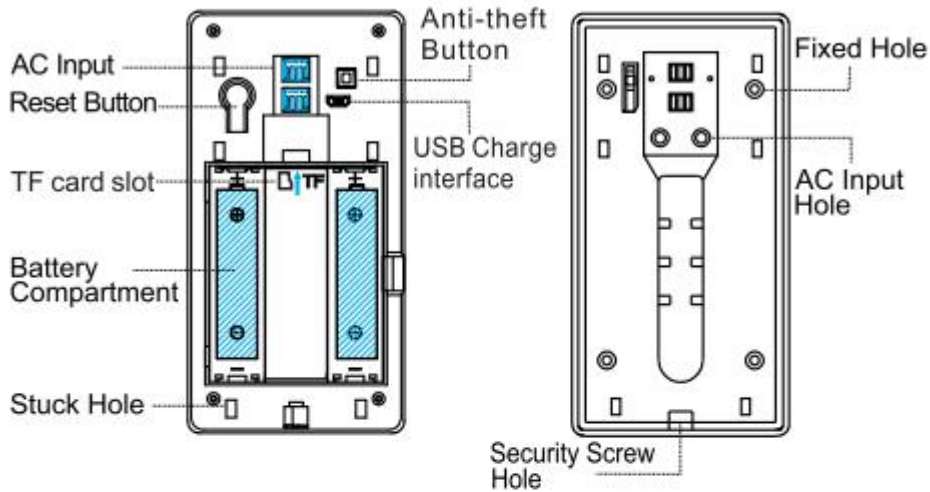

**AC Input** Power is supplied to the equipment by installing the AC input supply hole on the mounting bracket.

**Reset Button** Press 2~5 seconds to restore factory settings

**Battery Compartment** Mounting 18650 specification battery

**Fixed Hole** Fit the support on the wall with the mounting screws for the mounting kit.

**AC Input Hole** The power supply of the equipment can be supplied by connecting the hole and the AC power supply on the wall

**Anti-theft Button** When someone forcibly takes the doorbell, anti-theft button will trigger alarm, and both the APP and the doorbell will make alarm sound.

**USB Charge Interface** When the battery is low, no need to take out the battery, you can connect a 5V power adapter to charge the battery directly.

**TF card slot** Is used to insert TF card

**Stuck Hole** Mounting the equipment onto the bracket

**Security  
Screw Hole**

Mounting the security screw on the fittings to prevent the equipment from being removed

**3.Installation Guide**

**Note: The doorbell is with a pair of batteries, which are placed under the doorbell in the package box.**

**Please take out the batteries for the first time, place them in the battery compartment correctly (please refer to the guide about the positive and negative of batteries in the compartment), and the doorbell can be energized.**

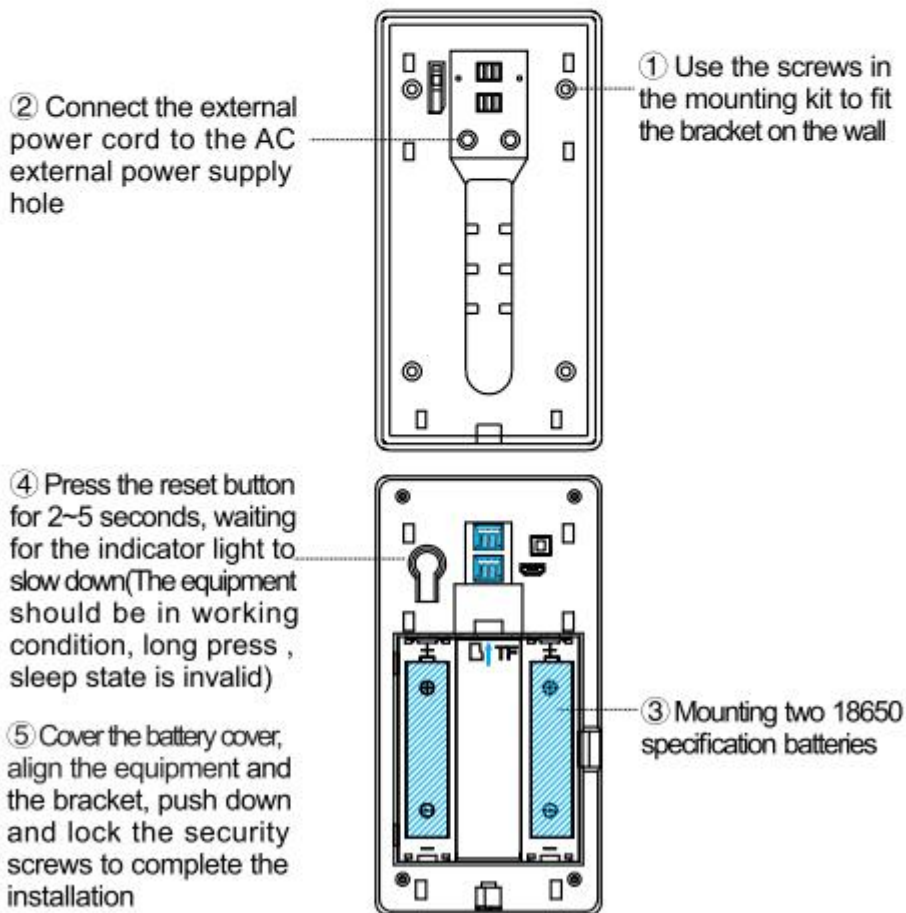

#### **4. Software download**

- ① Go to [www.eye4smart.com](http://www.eye4smart.com) to download the App.
- ② Search Eye4Smart in APP Store, Android market like Google play etc.
- ③ Scan the QR code below to download.



#### **5. Register**

- ① For Android/iOS APP, click on "Register now", create a user name and password to finish register.
- ② Also support the third party account login( no need to register).

#### **6. Add Device**

There are two methods to add the doorbell to smartphone, they are as follows:

##### **Method One: Scan QR code**

- ① Login the APP, click on "+" on the top right corner, choose 'Scan to add ', scan the QR code on the doorbell's sticker. Please make sure the light on the doorbell turned red and flash every 2 seconds. Tap the 'Red light flash every 2 seconds' and go next.



**Note: If the light did not turn red or flash every 2 seconds before the adding, please reset the doorbell to factory default.**

**(Reset Method: While the device is awake, press the green reset key at the rear of the doorbell for 2~5 seconds.)**

**The step ② for different phones are as follows:**



#### **Android devices**

To add the doorbell for the first time, please select the WiFi that the phone connected and input the WiFi password, then go to next step.



#### **IOS devices**

To add the doorbell for the first time, please follow the guide on the page, manually connect to the doorbell's hotspot @DoorBell-XXXXXX, (You can go to the 'settings-Wlan/WiFi, to find out

the doorbell wifi and connect to it, no need to put in the password), after connected to it, please go back to the APP, select the home WiFi, input the WiFi password and click to go to next step.

After finish the above settings of different phones, please follow the steps below:

The APP will start searching the doorbell, after the doorbell has been detected, the bind page will pop up, click on 'Add it' to add the doorbell. After successfully added, the doorbell will be shown in the home page of the APP and the light will be solid blue.

### Android devices

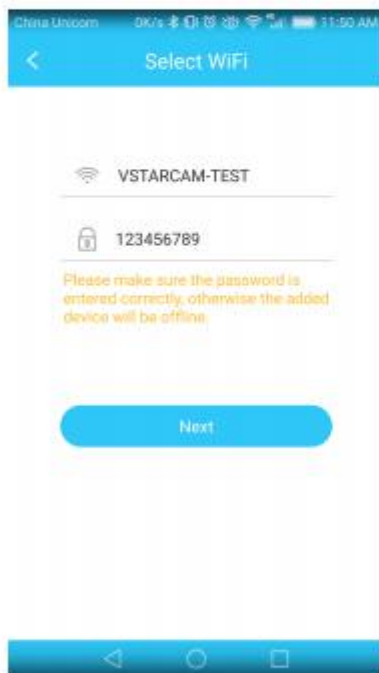

### IOS devices



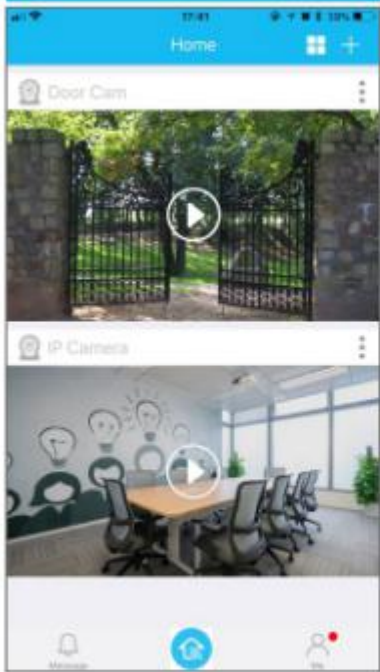
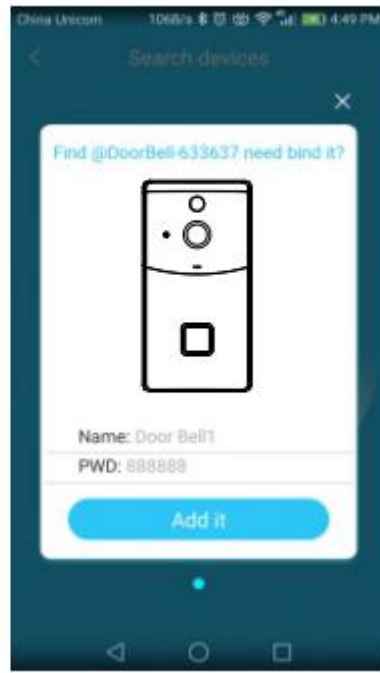

## Method Two: Other Ways to Add

① If it failed to add the doorbell via scan QR code, you can return to the home page of the APP, click on '+' button on the top right of the page, choose 'Others' → 'Door Cam'.



② Select the corresponding doorcam model, go next. Please follow the guide in the page, make sure the light turned red and flash every 2 seconds. Tap the 'Red light flash every 2 seconds' and go to next step.



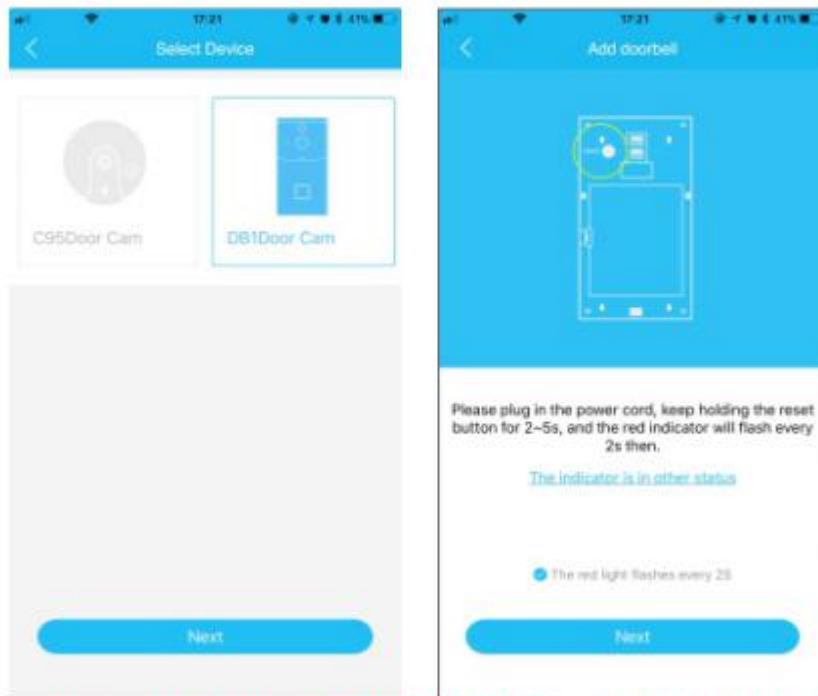

Then please refer to the step ② in Method One to finish the doorbell adding.

## 7. Indoor unit

### ① Appearance Introduction of Indoor unit

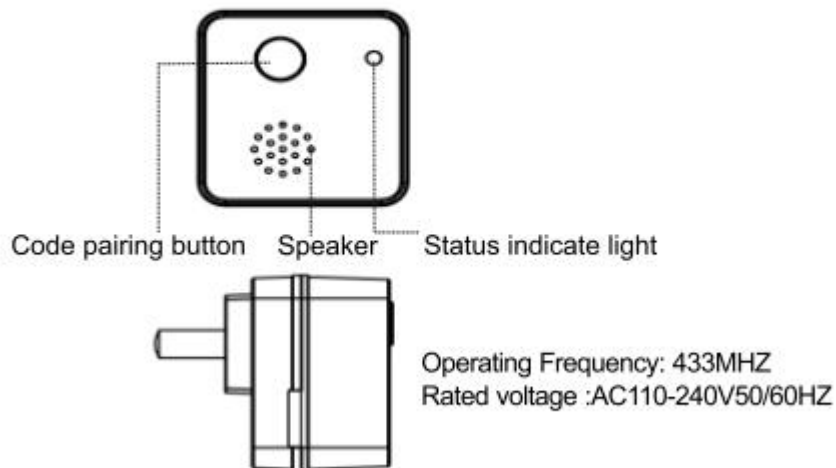

## ②Code Pairing and Usage

1) After setting up the wireless doorcam, please plug in the indoor unit. The doorcam and the indoor unit have already been matched when out of factory, when pressing the doorcam, the indoor unit will make a dingdong sound.

2) If the doorcam does not communicate with the indoor unit, please re-pair them. **Code pairing method:** While both the indoor unit and the doorcam are powered, short press the button on the indoor unit (the indicator light will be on and then off), then short press the doorcam button. If they are paired successfully, when you press the doorcam, the indoor unit will issue dingdong sound.

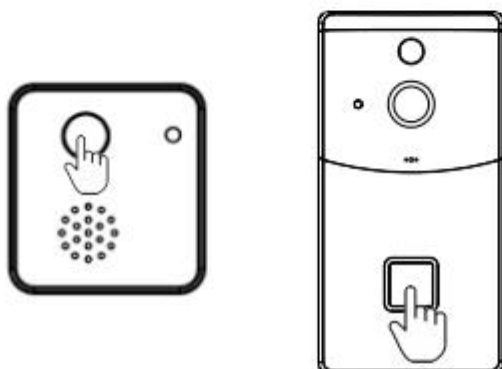

## 8. Use and Share

① When nobody pressed the doorbell or PIR is off, and no motion for about 30 seconds, the doorcam will enter sleep mode, power consumption will be the lowest.

When visitors press the doorbell, or the PIR is opened and detected visitors, the doorbell will be awakened, trigger alarm and take a snapshot, push it to the mobile phone. Meanwhile, the doorcam will issue doorbell sound. You can also check the alarm messages in the 'Information→Message' of the APP.

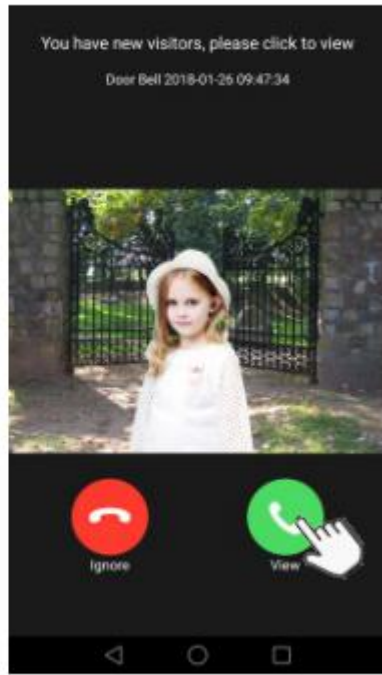
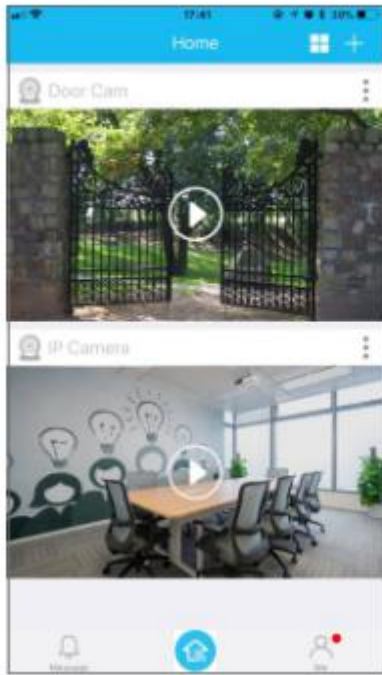





② In the home page of the APP, tap the  on the top right of the doorbell, go to the 'Settings' of the doorbell. We can open the ultra low power consumption function.

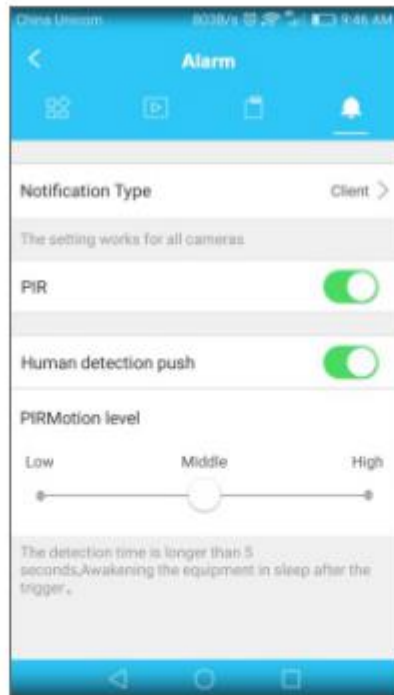

③ Click on the 'Alarm', we can enable the PIR. You can open the PIR and alarm push, set the sensitivity of the PIR, choose notification way(client or email). When the doorcam detects visitors, it will wake up, triggers alarm, take snapshots and push it to the phone or pushes alarm messages to the email.



## 9.Function and features

-  HD wide-angle lens
-  Support mobile phone remote fast wakeup
-  2.4G WiFi connection
-  High quality two-way instant audio with noise cancellation
-  Support PIR motion detection, when someone hovers at the door, speed pushing notification to the mobile phone

## FAQ

### **Q: Doorbell can't connect to WiFi**

- A: 1. Please make sure the WiFi is in 2.4G band.  
2. Make sure the red light is slowly flashing  
3. The WiFi password should be less than 16 digits, and can not contain special characters, such as @ ¥! etc. , suggest you to make a password that contains only letters and number.  
4. Please upgrade the APP to the latest version.

### **Q: The device is online and the alarm has been triggered, but can't get alarm message**

- A: 1. Enable 'auto boot' for the APP  
2. Allow the APP run in background.  
3. Enable the notification function of the APP.  
4. Close the 'Battery optimization' on the phone.

### **Q: What is the device's method of charging and discharging?**

- A: 1. The device can work alone with 18650 batteries.  
2. You can also recharge the built-in battery and it will also work.

## Service

More help needed, please refer to our

FAQ: <http://www.eye4smart.com/faq.html>

Email: [support@eye4smart.com](mailto:support@eye4smart.com)

QQ: 2851561239

Thank you very much for purchasing VStarcam products, if you have any problem, please feel free to contact us.



**3-05-01-007-3009**