

1. Packing List

Please make sure all accessories are included in your package:

Wi-Fi Photo smoke alarm×1
9V 600mAh lithium battery ×1
Manual×1
Screw bag×1

2. Product Description

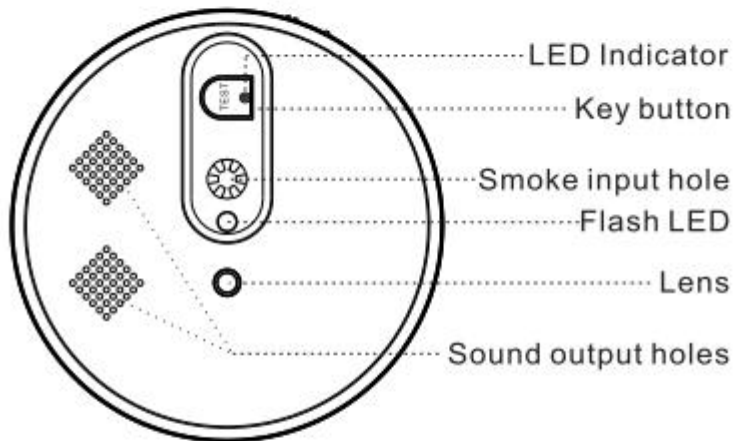

2.1 Alarm Specification

Photo Resolution : 800×600
Photo Format : JPEG
Image sensor : 2 MP 1/4 inch OV CMOS image sensor
Lens : 100°, F2.2 aperture
Transfer method : Wi-Fi 2.4G
Transmission distance : 30m
Night vision mode : Support with 1pcs make-up light
Power supply : 9V 600mAh lithium battery
Alarm horn : ≥95dB
Alarm detection range : 20m²
Standby current : ≤20uA
Operating current : ≤200mA

Operating temperature : -10°C ~ +55°C

Dimension : Φ115mmxH42 mm

2.2 Alarm Features and Functions

Key button	Press the button, photo would be taken and sent to APP, meanwhile alarm turn off after 3 sounds.
	Long press 5S the button for factory reset.
Smoke alarm	Detection frequency 1 time per minute.
	No smoke, no notification, no uploading.
	Smoke was detected, photos will be sent to APP every 15S (6 times), or closed manually through APP.
LED Indicator	<ol style="list-style-type: none">1. Waiting for network connection: Red LED light flashes 1 time per 1 second.2. Network interruption: Red LED light flashes 1 time per 3 seconds.3. Network connected: Red LED light off.4. Photo push: Red LED light fast flashes 10 seconds and off.5. Smoke alarm triggered: Red LED light fast flash continuously till closed manually through APP.6. Low-power alarm: Red LED light flash 1 time per 10 seconds
Make-up lighting	Red LED light is on for 5 seconds.

3. Application

Smoke Alarm detector are sensitive to smoke, dust, water mist and volatile gases, so not suitable for the places with large dust and water mist, such as the kitchen, bathroom and air vents with wind speeds greater than 5m/s(it is difficult to accumulate smoke in these places.) Better install on Living room, bedroom, study room, storage room, dining room, workshop etc.

4. Usage

Connect the 9V battery to the power cable and press it in the direction (the "+" of the battery is connected to the "+" of the battery cable, and the "-" of the battery is connected to the "-" of the battery). After connection will hear "beep" sound, and use the mobile app to complete the addition of the photo smoke alarm. Then press the test button, the alarm will give an audible and visual alarm prompt, while the camera fill light flashes and captures the photo, the mobile APP will receive an alarm message with a snapshot of the scene.

When there is smoke, after the intelligent judgment, the alarm indicator will flash and "beep" continuously, and send the dangerous photos to mobile APP.

5. Installation guide

The installation location is generally selected under the ceiling in the center of the room. For the sloping beam roof, the ceiling is also inclined, the angle of inclination of the alarm shall not exceed 45°, and the horizontal distance from the apex shall not exceed 0.9m.

Step 1: Fix the base to the ceiling with screws and plastic expansion rubber plug.

Step 2: Install the detector on the base by rotating clockwise

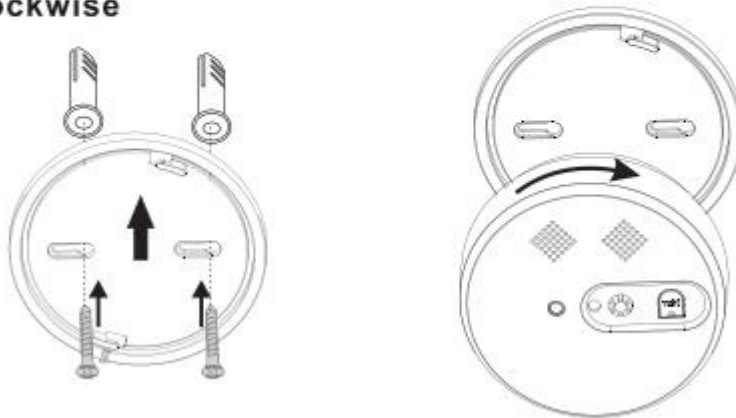

6. APP download

- ① Visit <http://www.eye4smart.com> to download the APP
- ② Search "Eye4Smart" in App Store, Google Play or other mobile phone application store.
- ③ Scan the QR code below to download.



7. Account sign up

Select the "sign up" on APP, complete the sign up by inputting username and pass code.

8. Add the device

Please follow the below three steps.

Step 1: After loading APP, click the "+" on top right. Two optional ways to add the device.

Option 1: Scan to add

Click "scan to add", then scan the code on the device label. Go to **step 2**.

Option 2: Others

If it failed to add by "Scan to add", then please refer to the "Others→photo smoke", then follow the prompt on the APP, go to **Step 2**.

Step 2: The connection operation steps of different mobile platforms are as follows:



Android users

① Please follow the instruction shown on phone. Make sure the alarm LED light flash 1 time per 1 second, go to next step.



Apple mobile users

① Please follow the instruction shown in iphone. Make sure the alarm LED light flash 1 time per 1 second and bluetooth is open on iphone, go to next step.



② First time to add the device, please input the connected home Wi-Fi password, go to next step. (The device does not support 5G network, please make sure the password is correct.)



③App would go discovering the device automatically, name the device and click "Add it", network will pairing device automatically, the device will show on the APP home page after connection successfully.

Notice:

For Android phone user, if there is no prompt of interface on the right picture, please refer to **step 3**.

For Apple mobile user, if there is no prompt of interface on the right picture, please reset the device and discover.

Reset Method: Long press the button, release when the red light flashes. After reset, the light flashes 1 time per second.



Step 3: Manual connection (Android phone user)

If the APP failed to detect the photo smoke, the following page will pop up, please follow the guide and the steps below to manually add the photo smoke :

Click "Manual connection" to turn out phone WiFi setting page. Select the device hotspot "**@SmokeAlarm-xxxx**", go back to APP and click "Add it". network will pairing device automatically, the device will show on the APP home page after connection successfully.



9. Use and Share

Alarm remind : Smoke was detected, photos will be sent to APP every 15S (6 times), or closed manually through APP.

Alarm share: click the "⋮" on top right, click "share" for other users scan the code.

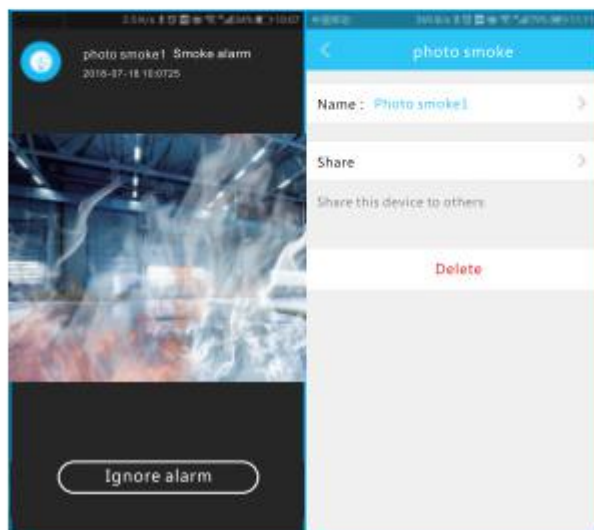

10. Product Feature

- ① Remote alarm when smoke happens at home.
- ② Alarm voice announcement and LED indicator flashing.
- ③ Snapshot of smoke crisis sent to phone APP immediately
- ④ Low power consumption, 1-year long standby.
- ⑤ Free cloud storage.
- ⑥ 95 dB alarm sound
- ⑦ Low-power status reminder.
- ⑧ Easy to install

11. FAQ

Q: Why can not add device to mobile app?

A: 1. Please confirm that the wireless network to be connected is 2.4G frequency.
2. Confirm that the device is in the standby state: the indicator light flashes for 1 second/time.
3. Check the Wi-Fi signal password connected to the mobile phone not exceeds 16 characters and not supported in @¥! special characters, we suggest WiFi password to be the letters plus a numbers.
4. If the mobile app has a new version, please upgrade to the latest version.

Q: The device is online and has push event, but the phone doesn't receive push information.

A: Turned on "self-starting" and the 'app permission' of the phone. Turned off the 'battery optimization' and 'End the APP at background and screen time'. (The mobile phone manufacturer optimization method is inconsistent, please refer to the actual situation).

Q: Can you warn of a gas leak?

A:No.

Q: What if no alarm when there is smoke?

A: If the alarm doesn't detect the smoke (it is a malfunction), please contact the supplier or customer service department to find out the cause of the problem and fix it as soon as possible. If the device doesn't detect the smoke in the room, the alarm will not work in an emergency.

Service

If you need more help, please visit our FAQ :

 <http://www.eye4smart.com/faq.html>

 support@eye4smart.com



3-05-02-007-3007
