

USER MANUAL



My safety, My rule!

Video Tutorial

If it is your first time to use our products, it is recommended to scan the following QR code to watch the video tutorial.



Product Description

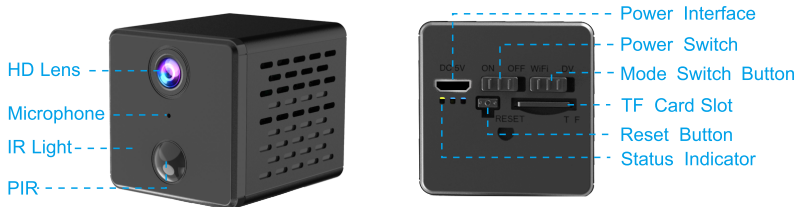

Reset Method: Turn the power switch to “On”, hold on the reset button for 5 seconds until you see the blue light and the green light turn on together , and then the blue light flashes slowly.

Device Description

- This device has two modes: IP Camera (WiFi) mode and Recorder (DV) mode.
- Built-in 1500mAh battery.
- Support DC5V/1000mAh power supply.

Indicator Status

Yellow light: always bright during charging

Blue light: slow flash---waiting for connection; fast flash---during connection; always bright ---connection success

Green light: slow flash---during recording; fast flash---does not insert a TF card

Restore factory: the green and blue lights are on, then the blue light flashes slowly

Step 1 : Pre-Setup

☑ Turn the power switch to “On”mode.

☑ Turn the mode switch button to “WiFi” mode.

☑ It is recommended to place the camera within 2 meters of the router.

☑ Connecting the phone to the WiFi and make sure know the exact WiFi password (only supports 2.4GHz).

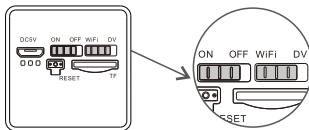

Step 2 : APP Download and Registration

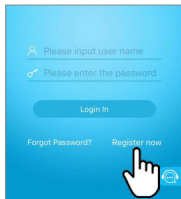

- 1 Search for “Eye4” in App Store or Google Play, or scan the QR code to download the app.
- 2 Click “Register”, enter the user name and password to complete the registration, and also supports the third party such as Facebook to login directly.

Step 3: Add Devices to the APP

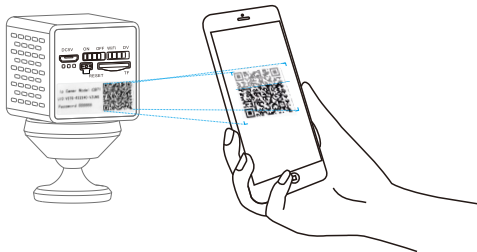

- 1 Open the app, click the “+” in the upper right corner , and scan the QR code on the body of the camera, then follow the prompts on the app to complete the adding. (Note: For Android phone, it will pop up some system permission window, please select “Allow”)

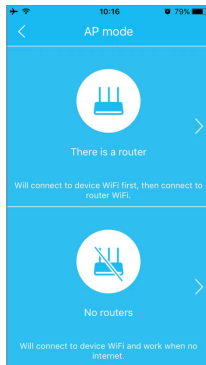
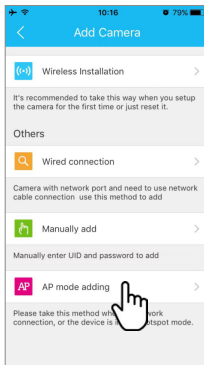
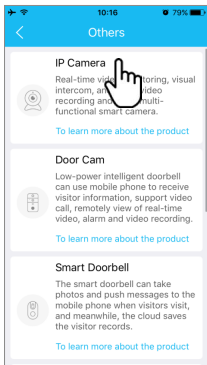

- 2 If you can't find the QR code, click the "+" in the upper right corner, select "Others" on the bottom right corner — "IP Camera"--- "AP mode adding", then select "There is a router" or "No router" according to the application environment.

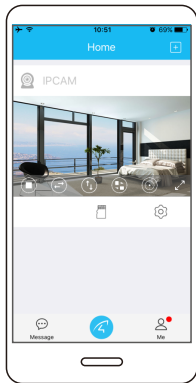

You're Done!

Wait for about 30 seconds, it will prompt "binding successfully" on the APP.

Click "Configure WiFi" and enter the WiFi password to complete the configuration.

Or enter "Settings" --- "WiFi" to complete the configuration.

Please write down your device information:

Eye4 account name: _____

Eye4 account password: _____

Configuring WiFi

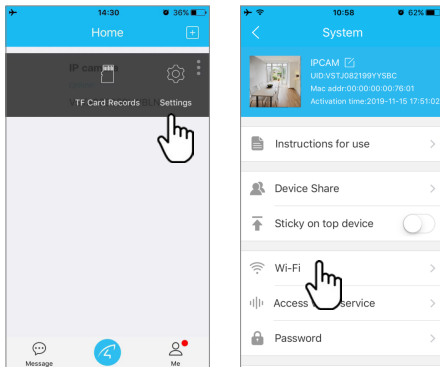

Click “Settings”----- “WiFi”, select the WiFi you want to connect, enter the WiFi password. About 60 seconds the camera restarts and the configuration is complete.

DV Mode Usage

高清镜头

麦克风

红外灯

PIR

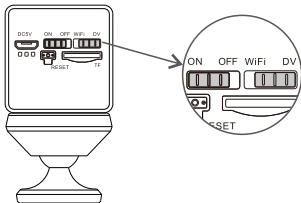

卡槽

Turn the power switch to “ON”, the mode switch button to “DV”, and insert a TF card for 24 hours of continuous recording.

How to view recording videos?

- 1 Turn the mode switch button to WiFi mode, enter the APP, and go to “TF card” to view.
- 2 Place the TF card in the card reader, then plug the card reader to the computer. you can view the video on the computer.

Device Share

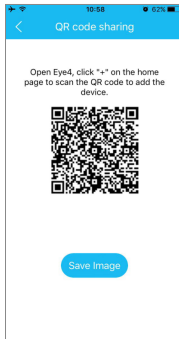
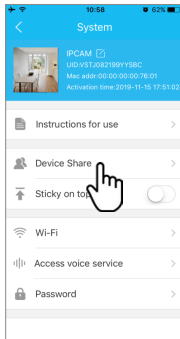

Click “Settings” on the right corner, then select “Device Share”--- “QR Code Sharing”. Other users can open the app and click the “+” in the upper right corner of the home page to scan the QR code to add the device.

After-Sales Service

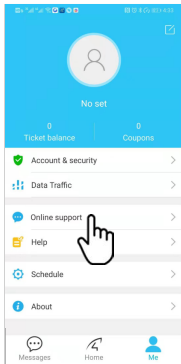

If you have any questions, please contact our customer service: Click on “Me” in the lower right corner of the APP. Select “Online Customer Service”.

Online customer service:

AM 8:30-12:00 PM 13:20-17:50 Night 19:00-23:00
on weekdays (UTC+8)

Official Mall : <https://shop.vstarcam.com/>
F A Q : www.vstarcam.com/support
Email : support@vstarcam.com



3-05-01-007-3049